

PTH300

OUTDOOR PAN & TILT

MAIN FEATURES

- Loads up to 12kg (26lb)
- IP66
- Optional preset
- Made of aluminium
- Standard autopan function
- 24Vac and 230Vac, 50/60Hz versions
- Internally adjustable horizontal and vertical limit switches
- Horizontal fixed speed 6°/s, vertical fixed speed 3°/s

DESCRIPTION

The PTH300 Pan & Tilt motor is suitable for medium duty outdoor installations with loads up to 12kg balanced. It is constructed from die cast aluminium construction protected by epoxy polyester painting.

It allows a maximum horizontal speed of 6°/s, a vertical speed of 3°/s and an horizontal rotation of 330°, vertical 360°. The Autopan function permits an automatic continual use of the horizontal rotation. A preset version is also available, equipped with potentiometers, which allows the preset by means of our telemetry systems.

Wide range of control systems are available, ranging from the simple CBZ desktop controller to the microprocessor controlled telemetry receivers and to the most advanced control keyboards of the range.



PTH300



PTH300

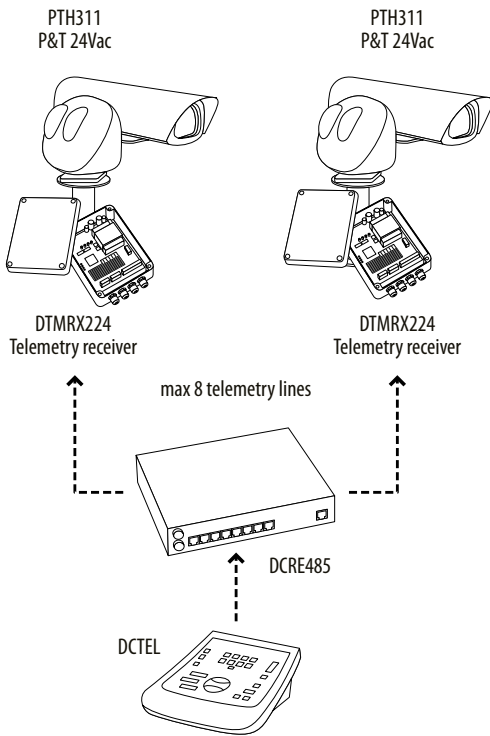

----> Twisted pair RS485 (max distance 1200m / 3937ft) telemetry only

AVAILABLE MODELS				
Model Number	Power supply	Autopan	Preset	Consumption max
PTH310	230Vac	✓	–	14W
PTH311	24Vac	✓	–	14W
PTH310P	230Vac	✓	✓	14W
PTH311P	24Vac	✓	✓	14W

TECHNICAL DATA

GENERAL

Constructed from corrosion-proof aluminium
 Epoxypolyester powder painting, RAL9002 colour
 Stainless steel external screws
 Mounting position normal / reverse
 Supplied with side bracket for camera housing and accessories for mounting

MECHANICAL

Dimensions: 144x161x180mm (5.6x6.3x7in)
 Load rating: 12kg / 26.5lb max (balanced)
 Horizontal plane movement: 0-330°
 6°/s fixed horizontal speed
 Pan Torque: 6Nm
 Horizontal limit switches, internally adjustable
 Vertical plane movement: 0-360°
 3°/s fixed vertical speed
 Vertical torque: 6Nm
 Backlash: Pan 0.17°, Tilt 0.07°
 Vertical limit switches, internally adjustable
 1 PG11 cable gland and 1 blanking cap for PTH300 models
 2 PG11 cable glands for PTH300P models
 Unit weight: 3.7kg (8lb)

ELECTRICAL

Power supply 24/230Vac
 Horizontal motor consumption 7W max
 Vertical motor consumption 7W max
 Standard Autopan
 Preset potentiometer linear 5kOhm multitrans (10 turns) (only PTH310P / PTH311P versions)

ENVIRONMENT

Indoor/Outdoor
 Operating temperature: -20°C / +50°C (-4°F / 122°F)
 Resistant to salty fog until 1000 hours (according to ISO9227)

CERTIFICATIONS

CE EN61000-6-3, EN50130-4, EN60065
 IP66 EN60529

RELATED PRODUCTS

CBZ220	Desktop controller for PTH310 pan & tilt
CBZ24	Desktop controller for PTH311 pan & tilt
DTMRX2	DTMRX Telemetry receiver 12 functions, 230Vac
DTMRX224	DTMRX224 Telemetry receiver 12 functions, 24Vac
DTRX3	DTRX3 Telemetry receiver 17 functions for series PTH300 + preset
DTRX324	DTRX324 Telemetry receiver 17 functions for PTH311 + preset
Housings	PUNTO, HEA, HEB, HEK, HEM, HOV, VERSO, VERSO COMPACT

BRACKETS AND ADAPTORS

PTAC	Wall bracket for PTH300 P&T
WFWBTA	Column bracket for PTH P&T series

SPARE PARTS

OPH3MAN	Maintenance kit
DOTPTH300	Installation kit for P&T PTH300

PACKAGE

Model Number	Weight	Dimensions (WxHxL)	Master carton
PTH310	4.1kg (9lb)	17.5x27x23cm (7x11x9in)	6

TECHNICAL DRAWINGS

Sizes in millimeters.

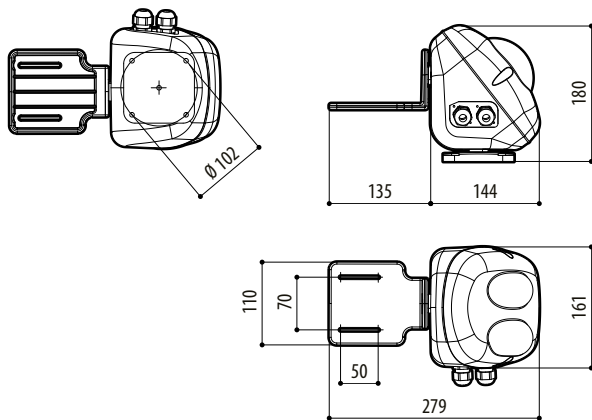

PTH300